

EASEMENT EXHIBIT
 FLAGG ROCHELLE COMMUNITY PARK DISTRICT COMMUNITY CENTER

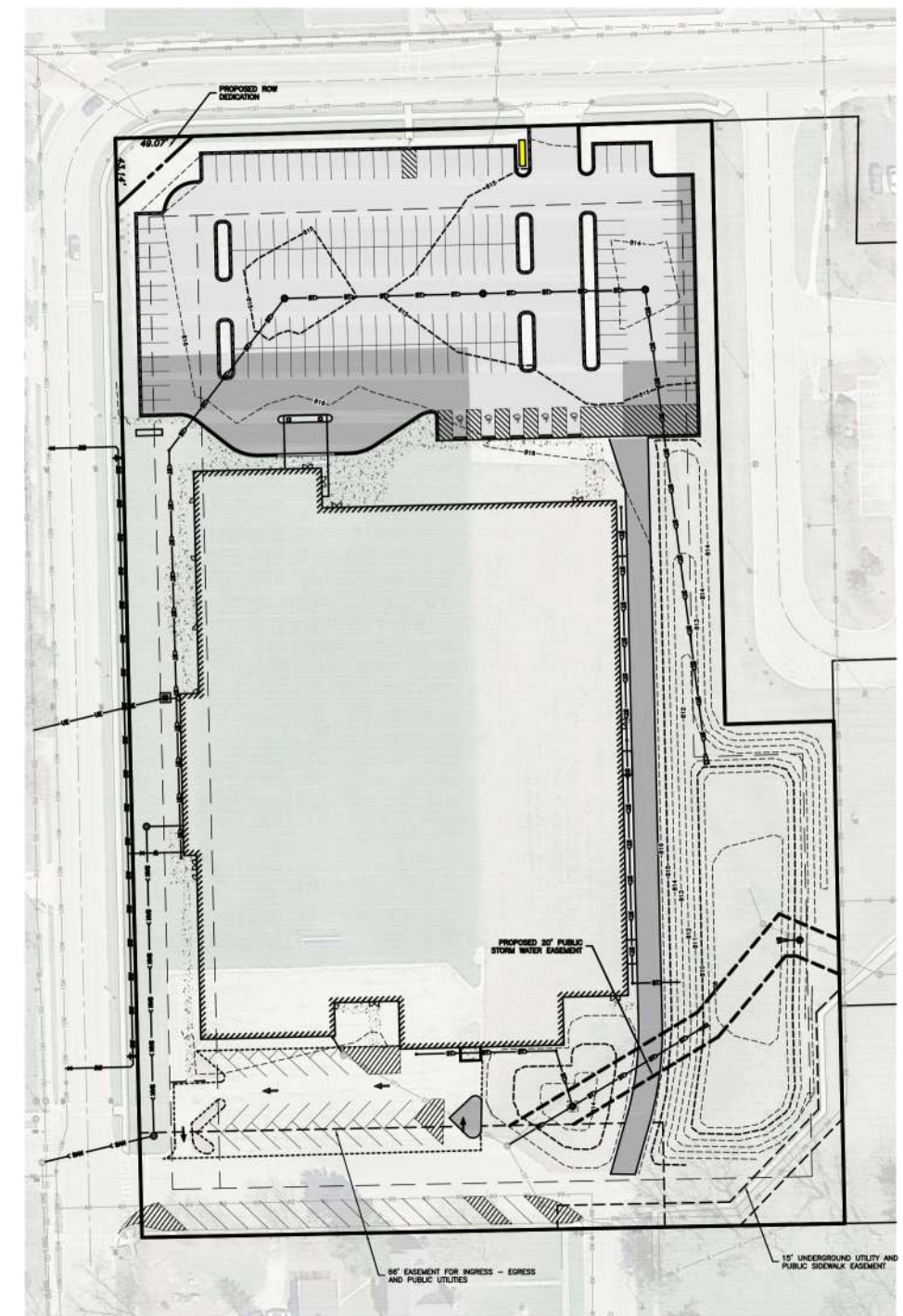

A

DOUBLE SIDED, INTERNALLY ILLUMINATED MONUMENT SIGN • FRONT & SIDE ELEVATIONS

SCALE: 1/2" = 1'



GENERAL SIGN CONTRACTORS

232 INTERSTATE RD. P.O. BOX 1068
 ADDISON, IL 60101

630-543-9490
 FAX 630-543-9493

DATE	REVISION
04.20.20	FLAGG ROCHELLE PANEL NOW SIZED @ 3'
	FIRST STATE BANK PANEL NOW @ 1' & MOVED TO BOTTOM
	EMC MOVED TO MIDDLE
04.24.20	2X10 EMC / 2" REVEAL -DT
12.23.20	REVISED OVERALL DESIGN - KM
12.23.20	REVISED EMC FROM AMBER TO FULL COLOR - KM

CUSTOMER APPROVAL _____ DATE _____

This design is the original and unpublished work of DOYLE SIGNS, INC. and may not be reproduced, copied or exhibited in any fashion without the expressed written consent from an authorized officer of The Company. The rights to this design may be purchased.

CLIENT	FLAGG-ROCHELLE COMMUNITY PARK DISTRICT						
ADDRESS	802 JONES ROAD						
CITY	ROCHELLE	STATE	IL	DESIGNER	DT	SALESPERSON	JST
DRWG. NO.	17956	SCALE:	NOTED	DATE:	04.13.2020	SHEET NO.	1